

INTEFFACE CONFORMS TO MIL-PRF-39012 TYPE NM

**MATERIALS:**

BODY COUPLING NUT, CONTACT— BRASS 1/2 HD PER ASTN-B-16  
 INSULATOR \_\_\_\_\_ TEFLON PER ASTM-D-1710  
 GASKET \_\_\_\_\_ SILICONE PER ZZ-R-765  
 SNAP RING \_\_\_\_\_ BERYLLIUM COPPER PER ASTM-B-196

**FINISHES:**

CONTACT \_\_\_\_\_ GOLD PLATED PER MIL-G-45204  
 ALL OTHER METAL PARTS — NICKEL PLATED PER QQ-N-290

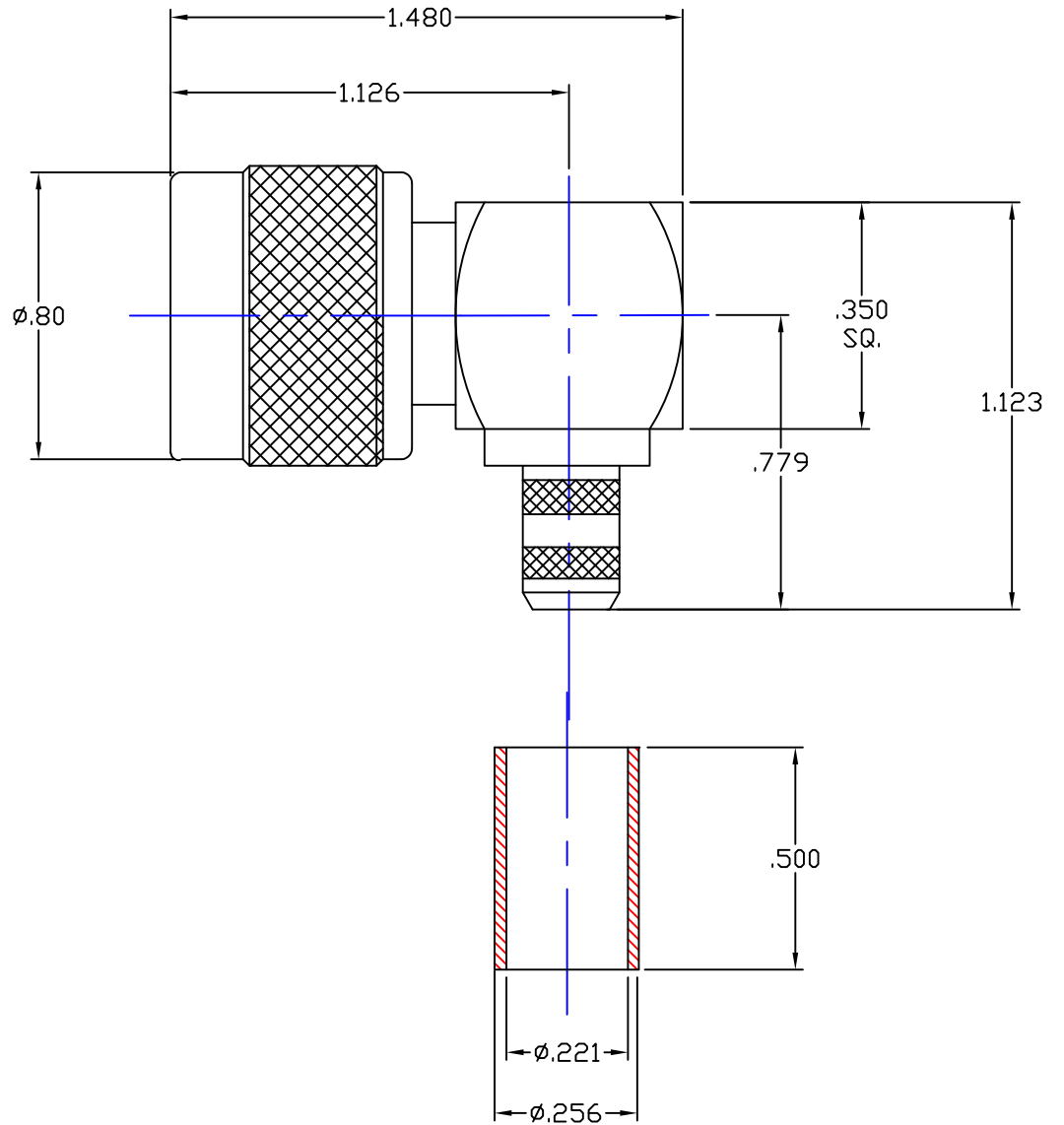

THIS DRAWING THE DESIGNS AND IDEAS EMBODIED IN THE DEVICE TO WHICH IT RELATES AND THE METHOD OF PRODUCING THE DEVICE SHALL NOT BE EMPLOYED COPIED OR DISCLOSED TO ANYONE IN ANY MANNER WITHOUT THE CONSENT OF ANVEZ FORM COMPANY OFFICIAL

APPD		
BY		
DATE		
DESCRIPTION		
REV.		

<b>UNLESS OTHERWISE SPECIFIED:</b>			
DIMENSIONS ARE IN INCHES:		SCALE	
TOLERANCES:			
DECIMALS:	FRACTIONS: ± 1/64		
2-PLACE ± .015			
3-PLACE ± .010	ANGLES: ± 3°		
MATERIAL: _____			
FINISH: _____			
DRAWN	DATE	CHECKED	DATE
P.J.P.	2-12-10	A.T.	2-12-10
APPROVED	DATE	SHEET	OF
J.A.B.	2-12-10		

<b>EZ FORM</b>			
CABLE CORPORATION			
HAMDEN, CT. 06517			
TITLE			
TYPE "N" MALE PLUG R/A			
FOR RG-58/U, 141/U, 303/U FLEXIBLE			
CABLE CRIMP			
<b>A</b>	CODE IDENT.		REV.
	<b>9W826</b>	CD-701200	-