

**RoHS
COMPLIANT**

NOTES:
INTERFACE AND ENVIRONMENTAL
REQUIREMENTS CONFORM TO
CECC 22 220 & IEC 60169, MMCX SERIES

ELECTRICAL SPECIFICATIONS:
FREQUENCY RANGE (GHz): DC TO 6 GHz
NOMINAL IMPEDANCE: 50 OHMS
VOLTAGE RATING (MAX. VRMS): 170
CONTACT RESISTANCE, CENTER CONTACT
(MAX. MILLIOHMS): 5.0
CONTACT RESISTANCE, OUTER CONTACT
(MAX. MILLIOHMS): 2.5

**MECHANICAL & ENVIRONMENTAL
SPECIFICATIONS:**
TEMPERATURE RATING (DEGREES CELCIUS):
-55°C TO +155°C
DURABILITY: 500 MATINGS
ENGAGEMENT FORCE: 3.4 lb. MAX.
DISENGAGEMENT FORCE: 1.4 - 3.4 lb.

MATERIALS:
BODY: BRASS PER ASTM-B-16
INSULATOR: TEFLON PER ASTM-D-1710
CONTACT & RING: BERYLLIUM COPPER PER
ASTM-B-196
CRIMP SLEEVE: COPPER ALLOY

FINISHES:
BODY: GOLD PLATE PER MIL-G-45204
CONTACT: GOLD PLATE PER MIL-G-45204

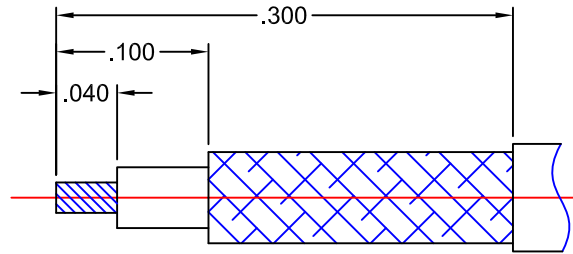
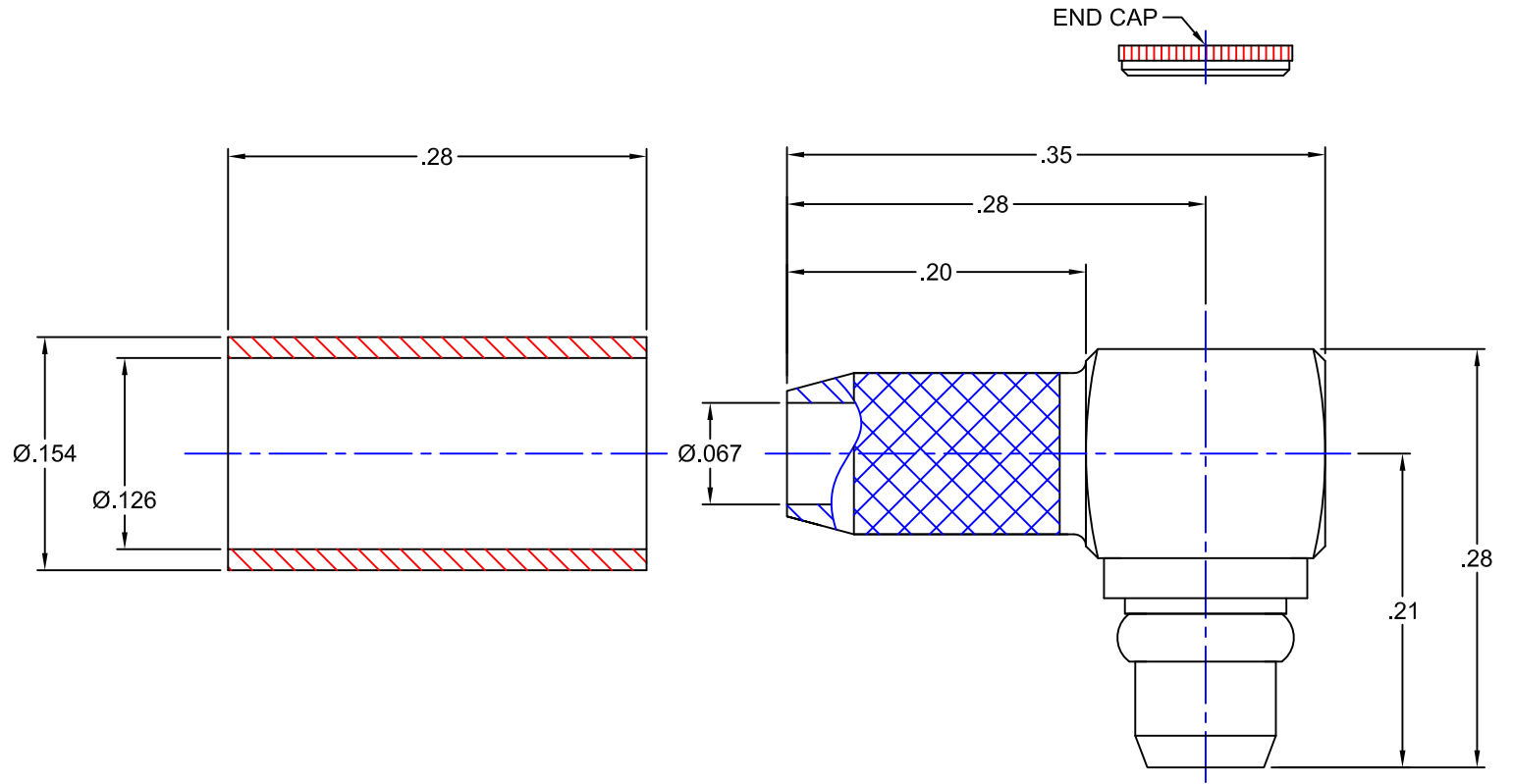

RECOMMENDED TRIM DIMENSIONS

CRIMP DIE: .128 HEX

PROPRIETARY NOTICE
THIS DRAWING AND DESIGNS AND IDEAS EMBEDDED
IN THE DEVICE TO WHICH IT RELATES AND THE
METHOD OF PRODUCING THE DEVICE SHALL NOT BE
EMPLOYED COPIED OR DISCLOSED TO ANYONE IN ANY
MANNER WITHOUT THE WRITTEN CONSENT OF AN
EZ FORM COMPANY OFFICIAL

APPD.	EW	
DATE	10/9/13	
BY	EW	
DATE	10/9/13	
DESCRIPTION	INITIAL RELEASE	
REV.	A	

UNLESS OTHERWISE SPECIFIED:			
DIMENSIONS ARE IN INCHES:		SCALE 8:1	
TOLERANCES:			
DECIMALS:	FRACTIONS: ± 1/64		
2-PLACE ± .03	3-PLACE ± .01		
ANGLES: ± 3°			
MATERIAL: SEE NOTES			
FINISH: SEE NOTES			
DRAWN	DATE	CHECKED	DATE
EW	10/9/13	AT	10/9/13
APPROVED	DATE	SHEET 1 OF 1	
JAB	10/9/13		

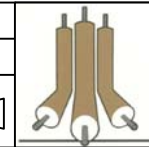

**EZ Form Cable
Corporation**
285 Welton Street
Hamden, CT 06517

TITLE MMCX RIGHT ANGLE PLUG FOR RG-316 CABLE			
A	CODE IDENT.	704001-316MMCX	REV. -
	9W826		