

INTERFACE CONFORMS TO MIL-PRF-39012 SMA SERIES

NOTES:

MATERIALS:

- BODY, COUPLING NUT, CONTACT \_\_\_\_\_ BRASS PER ASTM-B-16
- SNAP RING \_\_\_\_\_ BERYLLIUM COPPER PER ASTM-B-196
- GASKET \_\_\_\_\_ SILICONE PER ZZ-R-765
- INSULATOR \_\_\_\_\_ TEFLON VIRGIN WHITE PER ASTM-D-1710

FINISHES:

- BODY, CONTACT, COUPLING NUT \_\_\_\_\_ GOLD PLATE PER MIL-G-45204

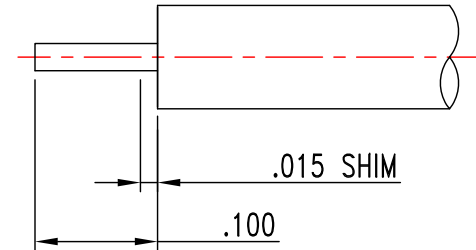
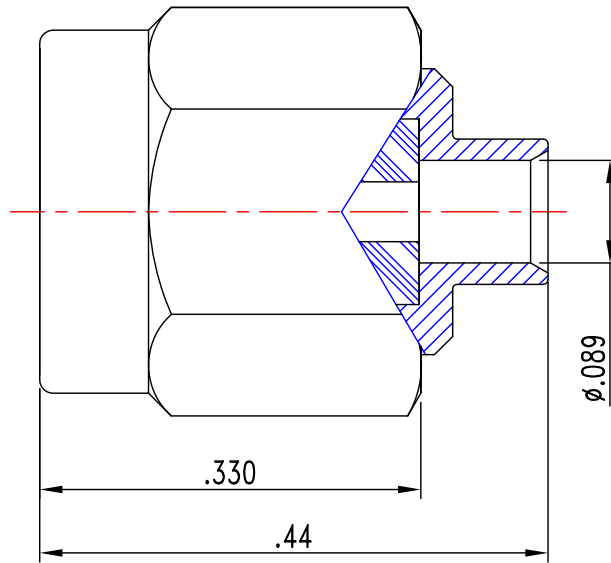

RECOMMENDED  
CABLE STRIPPING DIMS

THIS DRAWING THE DESIGN AND IDEAS EMBEDDED IN THE DEVICE TO WHICH IT RELATES AND THE METHOD OF PRODUCING THE DEVICE SHALL NOT BE EMPLOYED COPIED OR DISCLOSED TO ANYONE IN ANY MANNER WITHOUT THE CONSENT OF AN EZ FORM COMPANY OFFICIAL

APPD DATE	J.A.B 9/10/03	AT 12/24/14
BY DATE	P.J.P 9/10/03	DK 12/24/14
DESCRIPTION	INITIAL RELEASE	ECN# 9999
REV.	-	A

<b>UNLESS OTHERWISE SPECIFIED:</b>			
DIMENSIONS ARE IN INCHES:		SCALE	
TOLERANCES:			
DECIMALS:	FRACTIONS $\pm 1/64$		
2-PLACE $\pm .015$	ANGLES $\pm 3$		
3-PLACE $\pm .005$			
MATERIAL: SEE NOTES			
FINISH: SEE NOTES			
DRAWN P.J.P.	DATE 9-10-03	CHECKED T.A.R.	DATE 9-10-03
APPROVED J.A.B.	DATE 9-10-03	SHEET	OF

<b>EZ FORM CABLE CORPORATION HAMDEN, CT 06517</b>			
TITLE SMA MALE PLUG SOLDER ON CONTACT FOR USE WITH .086 SEMI RIGID CABLE			
<b>A</b>	CODE IDENT. <b>9W826</b>	705522-601SMA	REV. <b>A</b>