

RoHS  
COMPLIANT

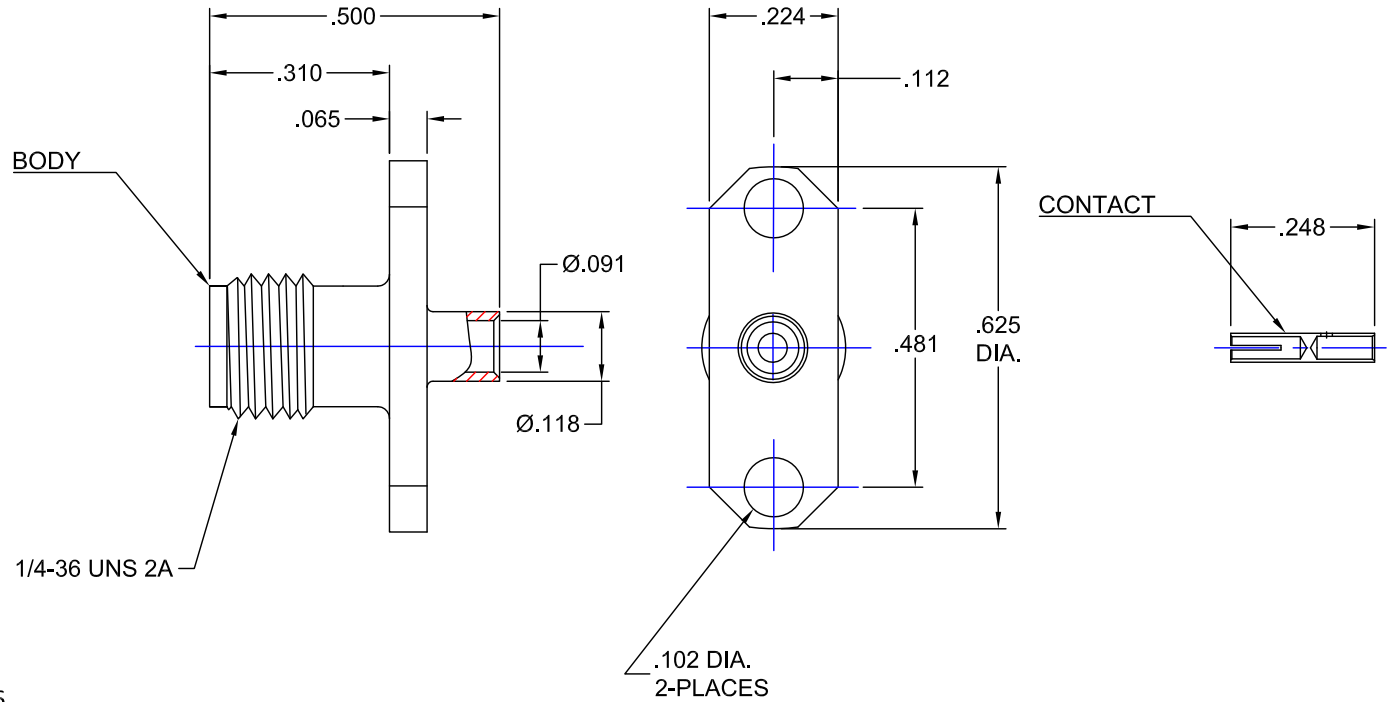

**NOTES:**

INTERFACE CONFORMS TO MIL-PRF-39012 AND MIL-STD-348 SMA SERIES

**ELECTRICAL:**

NOMINAL IMPEDANCE: 50Ω  
FREQUENCY RANGE: DC TO 12 GHz

**MATERIALS:**

INSULATOR: TEFLON PER ASTM-D-1710  
CONTACT: BERYLLIUM COPPER PER ASTM-B-196  
BODY: 360 ALLOY BRASS 1/2 HARD PER ASTM-B-16

**FINISHES:**

CONTACT: GOLD PLATE PER MIL-DTL-45204  
BODY: GOLD PLATE PER MIL-DTL-45204

PROPRIETARY NOTICE

THIS DRAWING AND DESIGNS AND IDEAS EMBEDDED IN THE DEVICE TO WHICH IT RELATES AND THE METHOD OF PRODUCING THE DEVICE SHALL NOT BE EMPLOYED COPIED OR DISCLOSED TO ANYONE IN ANY MANNER WITHOUT THE WRITTEN CONSENT OF AN EZ FORM COMPANY OFFICIAL

APPD.	TD
DATE	10/24/17
BY	TD
DATE	10/24/17
DESCRIPTION	INITIAL RELEASE
REV.	-

**UNLESS OTHERWISE SPECIFIED:**

DIMENSIONS ARE IN INCHES:  
TOLERANCES: NONE

SCALE  
3:1

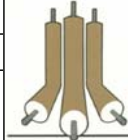

**EZ Form Cable Corporation**  
285 Welton Street  
Hamden, CT 06517  
WWW.ezform.com

MATERIAL: SEE NOTES			
FINISH: SEE NOTES			
DRAWN	DATE	CHECKED	DATE
TD	10/24/17	AT	10/24/17
APPROVED	DATE	SHEET 1 OF 1	
FV	10/24/17		

TITLE SMA 2 HOLE JACK FOR .086" S/R CABLE			
A	CODE IDENT.	705526-001SMA	REV.
	9W826		-